

THE
ENGLISH PANELLING
COMPANY



www.englishpanelling.com

01453 731305

How it all started....

20 years ago I wanted to put traditional style “tongue and groove” panelling in the bathroom of my Cotswold house. I did not want to use solid wood, as today’s softwoods invariably shrink leaving unsightly gaps, but I was unable to find an MDF sheet version that had realistic looking “joints” which would truly mimic traditional “butt and bead” detailing. So I set about designing my own and selling it through my furniture company **Scumble Goosie**. I called it our Georgian style - just a name really as you can use any of our designs in any age house - choose whichever looks most suitable!

We insisted on using only the best quality Moisture Resistant MDF and by selling it in manageable sheet sizes, that could be couriered with ease, it soon became a best seller! Realising that there has been a resurgence of interest in wall panelling we decided to expand the range to include alternative designs and **The English Panelling Company** was thus born.

The range has grown over the years and now comprises 5 styles in a number of size options. We have added dado and picture rails that are rebated to suit the thickness of the board we use making the job of finishing off the top of the panels even easier. If a more classical look is required our beading is available in pre-mitred sets to apply to the recessed panel type designs.

Please visit the website for more information or simply give us a call and we can talk through the options with you to help you make your choice and assist with estimating the number of panels you need.

We look forward to hearing from you!

Best Wishes,

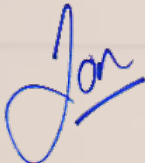

Founder, Scumble Goosie and
The English Panelling Company



CONTENTS

SOLID PANELLING

Solid sheets of 9mm moisture resistant MDF with butt and bead grooving cut into one face. They can be applied direct to wall or onto studwork/battens as required.

Two designs available in 3 sheet sizes:

GEORGIAN STANDARD JOINT

GEORGIAN WIDE JOINT

OPEN BACKED PANELLING

Sheets of 9mm moisture resistant MDF with squares or rectangles cut out from them. Once they have been bonded to a flat surface and painted the appearance of traditional recessed panelling is extremely convincing but achieved at a fraction of the cost.

Four designs available in a variety of sizes:

EDWARDIAN

VICTORIAN

REGENCY

JACOBAN

MOULDINGS

SOME COMMON QUESTIONS

INSTALLING AND SETTING OUT

PANELLING STAIRCASES

A BIT ABOUT SCUMBLE GOOSIE!

PRICES AND DIMENSIONS

CONTACT DETAILS AND SHOWROOM

GEORGIAN

(SHORT, TALL OR FULL SIZE)

The most realistic “butt and bead” effect board on the market! Ideal for bathrooms, utility areas, halls and wherever a less formal or more “rural” look is required. Georgian can be fixed direct to battens if the walls are very rough and it is also the easiest to run up staircases. Two variations: the “Standard Joint” has grooves 15cm apart and the “Wide Joint” has them at 20cm apart (price and sheet size is the same for both).



Our **Georgian** panels look equally stunning in traditional and contemporary settings. **Above: Standard Joint** used in a traditional setting and finished with Dado rail. **Left: Wide Joint** used with a more modern styled timber capping. There is also the option to fit panelling to studwork which not only conceals the pipework but also creates a useful shelf detail. This also allows insulation to be used between the studwork if desired. (Both these bathrooms use our 1200mm high panelling cut down as necessary).



Above: Full Size Georgian Wide Joint gives a light and airy feeling to this hallway.

Right: Full Size Georgian Standard Joint on a Vanessa Arbuthnott brochure cover.

Below: Full Size Georgian Wide Joint and Radiator Table from **Scumble Goose**.



Joint detail



Standard Joint on 600mm wide panel



Wide Joint on 600mm wide panel



Georgian is the easiest of our designs to run up staircases. Simply cut our **Full Size** or **Tall** sheets into parallelograms to suit the angle of your stairs.



EDWARDIAN

(TALL OR SHORT)

The simple slim rectangles that feature in this design make it equally suitable for contemporary as well as more traditional spaces and can even provide a “Shaker” look through use of appropriate colours and a plain skirting board. Available in two heights, 800mm and 1200mm, but remember to allow for dado and skirting to calculate *overall* height.

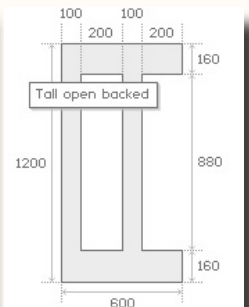

Left:
Tall Edwardian panels can add interest to the most boring of hallways!

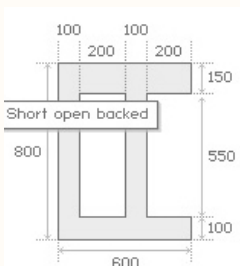

Right: *A customer sent us this lovely image of Short Edwardian used in their bedroom.*



REGENCY

(SHORT ONLY)

This design has a large “panel” size making it suitable for larger rooms. It gives a lovely feeling of space and helps to improve proportions in rooms with tall ceilings. As with all our open backed panel designs the square edged recesses can be made more ornate simply by adding our 9 x 20mm ogee beading. We sell this in 2.4m lengths but for Regency we are able to provide it pre-mitred to make the job even quicker!

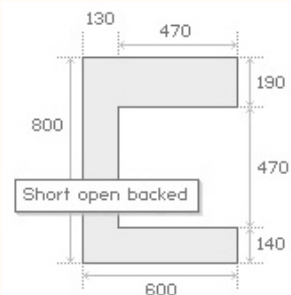

Right: Regency is available in just one size and is shown here with optional ogee beading for a more classical appearance.



Below: Regency (without the beading) was used on the front cover of The English Home magazine.



VICTORIAN

(SHORT)

This design differs from Tall Victorian in one very important respect. The bottom rail of the frame is “missing” so that the panels can be “stacked” vertically up to the required height. This enables the entire wall to be panelled or alternatively just up to a picture rail as shown below. Use our 100 x 1200mm framing strips to complete the lowest rail. Short Victorian can also be used in a single row just up to dado rail but remember that the bottom rail will add 100mm to the 800mm panel height.

A similar look to this but with squares instead of rectangles can be obtained with our Jacobean panelling (see later).

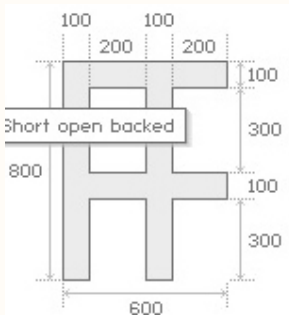

Above: This office was panelled using two rows of **Short Victorian** which, together with the bottom rail, skirting and picture rail, gave an overall height of 185cm. Why not splash out on some tasteful wallpaper...you won't need much!

Left: **Short Victorian** in a spacious bathroom. Note the bottom rail increases the overall panel height to 900mm (plus skirting and dado).

VICTORIAN

(TALL)

The taller version incorporates the bottom rail to give an overall height of 120cm (plus dado rail and your skirting board of course).

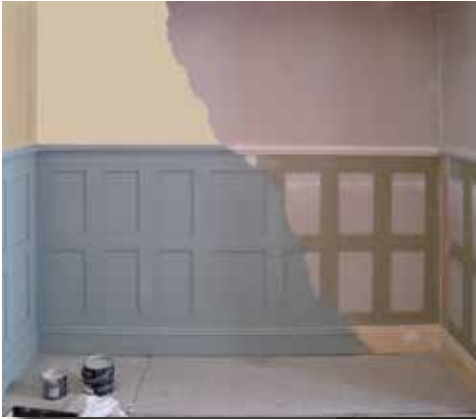

*Work in progress! This bay in the **Scumble Goose** showroom was created by bonding the panels directly to the plasterboard wall.*

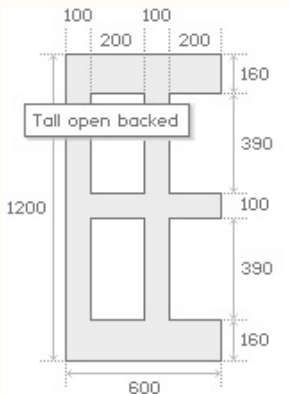

*Here our **Simple Dado Rail** has been aligned flush with the top of the panels so that the amount of rail left showing (about 100mm) is the same as for all the other rails. The bottom rail of the panel has been tucked 60mm below the skirting for the same reason.*



JACOBEEAN

(SMALL)

Ideal for creating the traditional English panelled study look but perfect also for where a feature wall is called for. As with Short Victorian, the bottom rail is “missing” so that the panels can be “stacked” vertically to the required height. Because they are square, the panels can also be used horizontally, making Jacobean possibly the easiest of the Open Backed designs to install. Pre-mitred beading sets are available for this design if a more ornate look is required.



Above: This customer used two rows of **Small Jacobean**, one placed vertically and one placed horizontally, to add the fourth square to the height. With picture rail, bottom framing strip and skirting this gave an overall height of 183cms. Note how they packed out the vertical end rails slightly to avoid the need to cut any of the squares. This is easy to do with an extra framing strip cut down to suit.



Above: **Small Jacobean**, used to great effect as a feature wall in a traditionally styled bathroom.

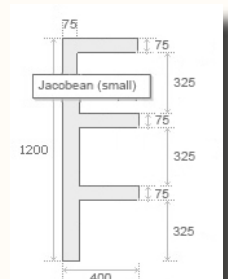

JACOBEOAN

(LARGE)

A scaled-up version of the Small Jacobean with larger recessed panels and thicker rails makes the Large Jacobean ideal for bigger rooms or where a less “busy” appearance is desired.



Above: Three rows of **Large Jacobean**, laid horizontally, have been fitted with our ogee beading to give a more solid classical statement in this room, which features heavy oak beams on the ceiling. Note that the panels have been built straight off the skirting rather than using a framing strip as the starter rail, an option that can be used to reduce overall height if necessary.

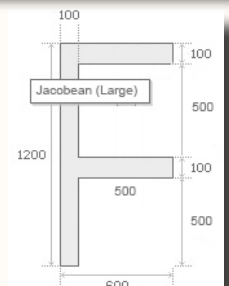

Left: Also note how this customer chose to cut down the panels at either end of the wall. This is ideal when there are an even number of squares, as there is no option to adapt the “centre square” instead. However the symmetry is retained and so this works very well.

MOULDINGS

We do not supply Skirting boards as they come in a huge variety of shapes and sizes and are readily available from your local builder's merchant or DIY store. However good quality timber mouldings **are** harder to find so this is what we sell! Whilst high quality MDF is ideal for the panelling, we are not big fans of using it for our mouldings as a crisper and truer profile is possible using best quality Scandinavian Redwood instead.

DADO RAILS

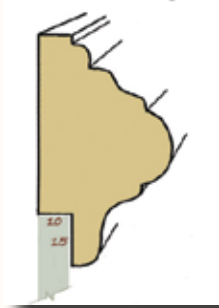

DADO1 Deep Rebated Dado
(39mm x 67mm h)

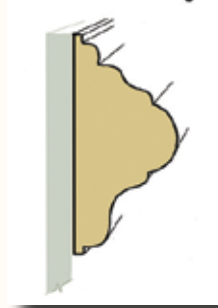

DADO2 Simple Dado
(26mm x 57mm h)

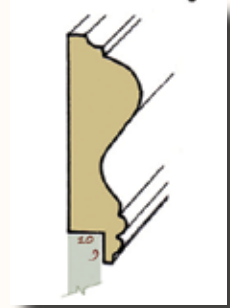

DADO3 Shallow Rebated Dado
(39mm x 67mm h)

Choose between face-fixed or sit-on (rebated) profiles. Although supplied in 2.4m lengths, we suggest you allow 2.0m of coverage per rail as mitring for corners will inevitably incur a wastage factor that needs to be allowed for.

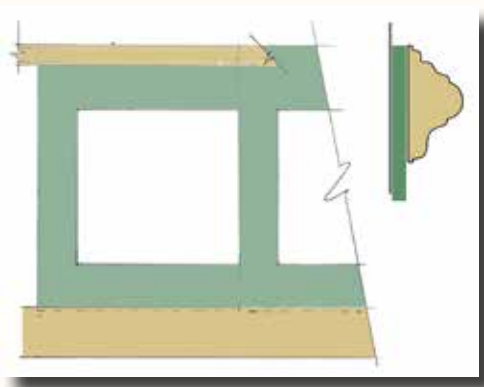
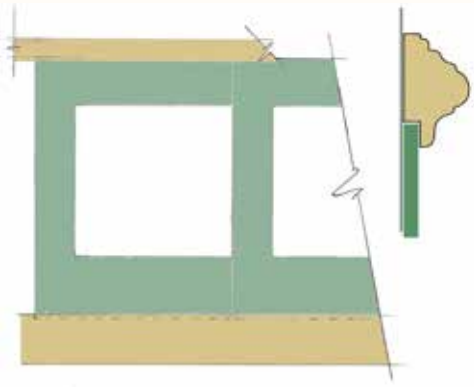

Above: Any dado can be used with all of our designs although rebated is ideal for Georgian as it conceals the tops of all the grooves. Above we show that on Regency, for example, the panel can be used either way up and with different dados to give a choice of final finished heights. By using the deeper rail at the top with the dado fitted flush with the top edge, a lower overall height is obtained as the dado height is contained **within** the panel instead of **adding** approximately 50mm to it.

MOULDINGS

PICTURE RAILS

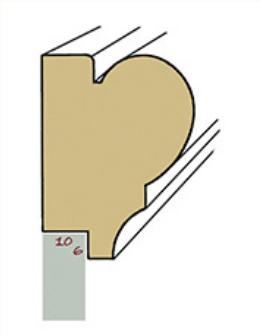

Right: The perfect way to finish off the top of panelling taken to picture rail height (this is usually around three quarters of the overall wall height). It also has the added benefit of providing a means of hanging pictures using traditional brass hooks!



OGEE BEADING

A classic profile bead mould that can be used to create a more ornate panel detail on any of our Open Backed designs. It can also be used as a “stop” bead if required. Supplied in 2.4m lengths or in pre-mitred sets (of 4 pcs) for our Regency and Small Jacobean designs. 9 x 20mm wide.



Left: Application of beading to the inner edges of the panels can enhance the appearance by creating more of a classical look but it is not always necessary and it can always be added on afterwards if you are not sure.

NB With the pre-mitred option remember to order one set for each **square**!

SOME COMMON QUESTIONS...

What is Open Backed Panelling?

Quite simply these are sheets of MDF with squares or rectangles cut out from them. They need to be glued to a reasonably flat smooth surface so that once painted they take on the appearance of solid wood recessed panelling. The results are very convincing but with several major advantages over “the real thing”...

- Massive savings compared with traditional wood panelling.
- Much quicker to install - many rooms can be done in a day.
- Only 9mm thick so minimal disruption to existing features.
- Easy to decorate, and to redecorate when a makeover is required.
- Won't expand and contract unlike traditional timber.

What if my walls are not in good condition?

Walls in poor condition can be patch-repaired or re-plastered prior to panelling but you may find it easier and cheaper to simply line them with thin mdf bonded to the walls or, if they are really uneven, batten the wall out first and dry line with plasterboard/9mm mdf. Using our Solid Backed (Georgian) panels is less of an issue as the panel will obviously completely cover up the wall behind it. Consult a reputable builder/handyman if you are in any doubt as to what you need to do and always ensure that any sources of damp have been eradicated so that the walls are dry before panelling.



Customer's image showing how they lined the walls first with 4mm mdf prior to installing our Short Victorian panelling and Deep Rebated Dado rail. Lining is only necessary if the walls are in poor condition as normally the Open Backed panels can be glued directly to the plastered surface.

SOME COMMON QUESTIONS...

Can I retain my existing skirting boards?

Most types of skirtings, particularly in older properties, have a bit of a horizontal “ledge” at the top for the 9mm thick panels to sit on. If you have “Bullnose” type skirtings with a rounded top then this won’t work so you might consider replacing the skirting (which means you can choose one that is more in keeping with panelling).

Can I use your panels in Kitchens and Bathrooms?

We use only the best quality Moisture Resistant MDF made in the British Isles. It is suitable for the humidity to be found in these rooms as long as the panelling is painted using a good quality eggshell paint (or paints specifically intended for kitchens and bathrooms). Apply good basic design principles such as ensuring that the panels do not “sit” in pools of water. Leave a 10mm gap between the floor and any panels (this will be hidden behind the skirting) and if panelling down to the top of a bath, basin or worktop ensure that the silicon sealant slopes away from the wall.

Why do I need Framing Strips?

When using our Open Backed designs Framing Strips can be used along with offcuts from the panels in the following ways:

- 1) They can be used to complete the end of a run (ie the last vertical rail).
- 2) When working from both ends towards the middle of a run a framing strip is sometimes needed when adapting the centre panel/s (see section “Setting Out”).
- 3) With Short Victorian and Jacobean panelling Framing Strips are required to complete the bottom rail.
- 4) They can be used to pack out small gaps if an exact number of panels does not quite make up the total run length. Use either end to maintain symmetry.
- 5) They come in handy for packing out skirtings, picture rails etc.

As a rule of thumb we suggest one Framing Strip per run of panels. A run is defined as a length of panelling so a wall with a doorway in the centre would count as two runs. **N.B.** Allow for the bottom rails in addition to this if you are using our Short Victorian or Jacobean designs.

Use Framing Strips (shown here in green) to close off any adapted sections of all of our Open Backed designs and for the bottom rails on the Jacobean and Short Victorian designs.



INSTALLING AND SETTING OUT

THE BASIC PRINCIPLES

Symmetry is always key when deciding how to set out your panelling. Establish the centre of each run and work out from there towards the ends or, alternatively, from the ends back towards the centre - whichever works out best with the panel design you are using and taking into consideration location of sockets etc.

Georgian is fairly straightforward as the grooves are at regular intervals and so aside from ensuring that any cut down boards are equally spaced at each end (see image on the right) there is not much else to worry about!



Our Open Backed panels require a little more thought and it is often worth just loose-laying them against the wall in question to see how they look and to check whether it is better to work out from the centre of the run or back towards it. Inevitably there will be some cutting down of a panel or two on each run. As long as symmetry is maintained it will be pleasing to the eye and once the panels and wall have been decorated everything will come together and the reduced/enlarged panels will simply blend in with the rest.

Here is an example of how some typical short runs can be dealt with. In this case we show Short Victorian but the principles are the same for all Open Backed types.

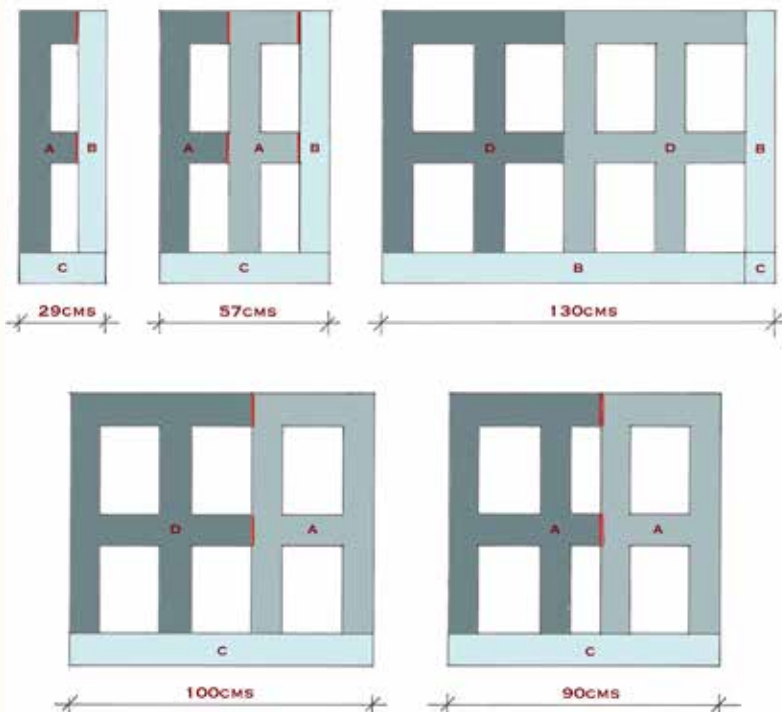

A = cut down panel (cuts shown in red).

B = full length Framing Strip (either 80cm or 120cm).

C = cut down Framing Strip.

D = full size panel with no cuts.

N.B. The bottom run of framing strips will only be required if Short Victorian or Jacobean panels are used. The other types already have the bottom rail as an integral part of the panel.

INSTALLING AND SETTING OUT

EXAMPLE USING TALL VICTORIAN WITH NEW SKIRTINGS

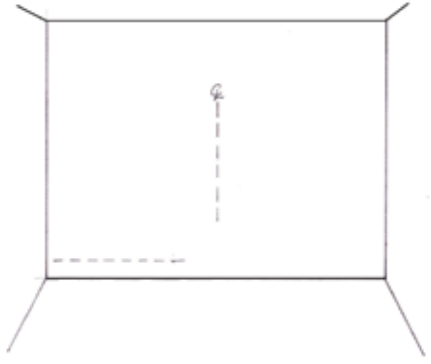

Establish the centre of the wall and height of skirting and mark on the wall.

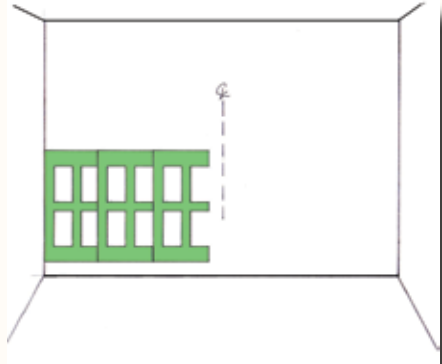

Position panels 10mm below skirting line and work towards the centre. Pin corners to ensure they don't slip whilst drying.

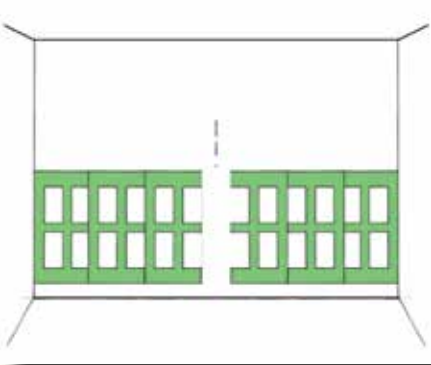

Work from opposite side checking that top edges will line up with each other.

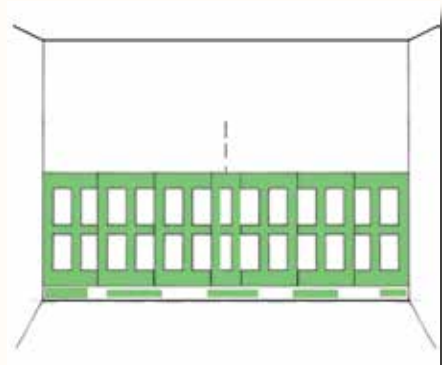

Establish size of resulting centre panel and adjust accordingly. Use offcuts/Framing Strips to pack out for skirting.

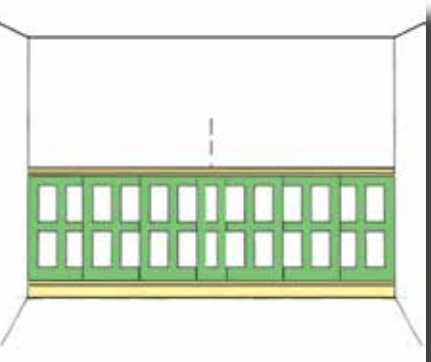

Fit Dado and Skirting boards. Sand and fine-surface fill as required and remove (or hammer home) any pins used.

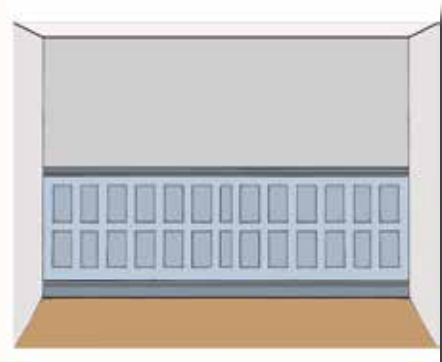

Decorate. Stand back. Admire!

INSTALLING AND SETTING OUT

EXAMPLES USING REGENCY ON VARIOUS RUN LENGTHS

45cm run

A Framing Strip (13cm wide) forms one side and a panel is cut down to fill the remaining space (32cm).

For runs less than 25cm we suggest **no squares**: use plain 9mm mdf and just paint in same colour as panels to maintain continuity.

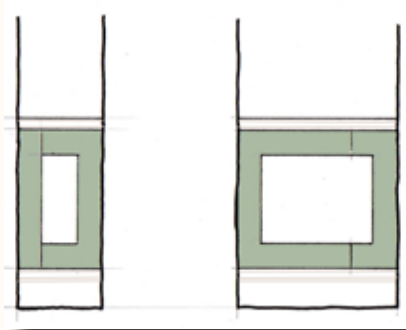

85cm run

One whole panel (60cm) is used for one side and another is cut down to fill the remaining space (25cm)

For wider runs use a divider as shown in the next diagram otherwise the square starts to look too squat.

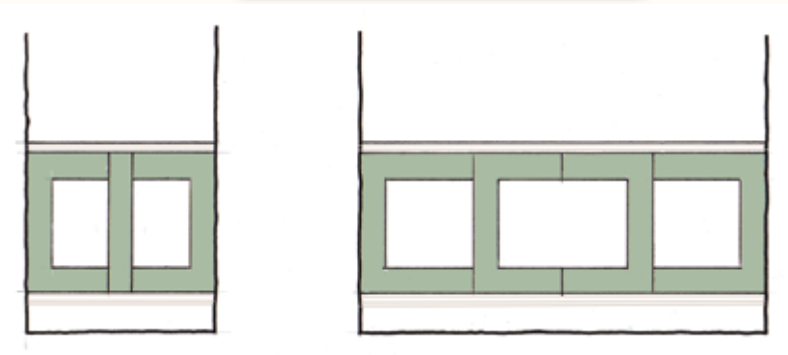

100cm run

Two panels have been cut down to meet a Framing Strip centrally placed as a divider.

215cm run

Two whole panels have been placed alongside two panels cut down to fill the remaining space.

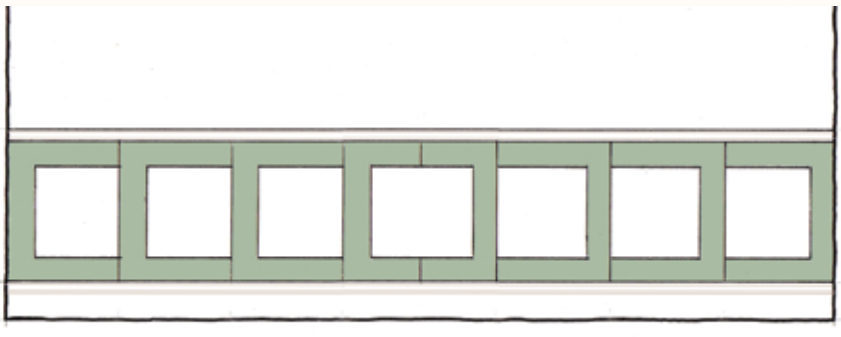

443cm run

Three whole panels have been placed either side of two panels cut down to fill the centre (which in this case is 10cm wider than a whole panel). The alternative would be to use seven whole panels (plus one Framing Strip), and then pack out the 5cm gaps either end using cut down slithers of a Framing Strip. This would produce a slightly wider vertical rail in each corner but symmetry is maintained.

INSTALLING AND SETTING OUT

DEALING WITH CORNERS

The diagrams **below** illustrate two alternative ways of dealing with corners. Here Regency is shown on an external corner but the same principles can be applied to any of our Open Backed designs and indeed internal corners can be treated the same way. It will depend on each individual situation as to which works best and again we suggest drawing pencil lines on the wall and then standing back to see what looks best! Note that with Option 1 two framing strips (coloured green) will be required.



CORNER OPTIONS

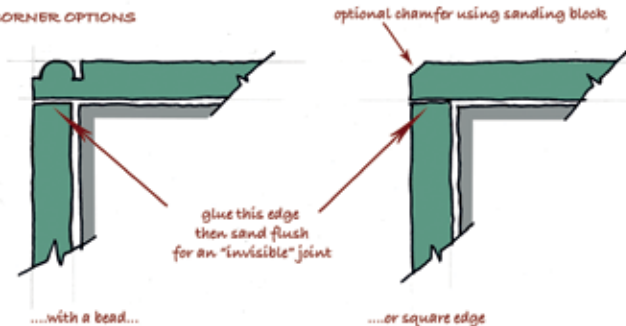

With the Georgian design the treatment of corners is more straightforward as there are no recessed panels to worry about.

For the detailing of the corner itself see the diagram (left) which offers two options.

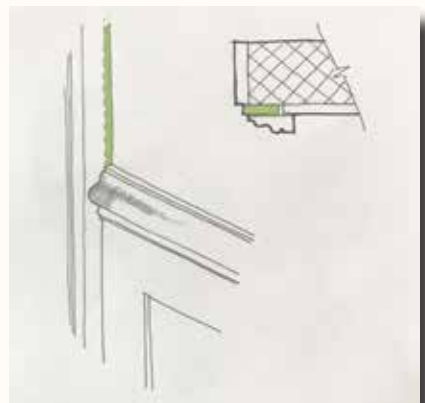

Right: Although the panels are only 9mm thick it is sometimes necessary to pack out architraves so that the panels and dado run neatly into them. This can easily be done using 9mm thick planed stripwood (widely available from DIY stores/Builder's Merchants) and shown here in green. A quicker alternative solution would be to chamfer back the dado to meet the corner of the architrave.

INSTALLING AND SETTING OUT

GLUING THE PANELS AND DEALING WITH SOCKETS

Use a panel adhesive for our Solid Backed Georgian designs (eg No Nails or Gripfill). A bead all round the perimeter 2cm in from the edge and then a zig zag across the rest. However, with our Open Backed panels, it is important to get a tighter fit against the wall so we recommend a generous coating of PVA glue for these. Use a mini roller and ensure that it is fully coated. Press panel to the wall, secure (either temporarily or permanently) with pins in the corners to hold it whilst the adhesive sets and go around the edges with a dry brush to mop up any glue that squeezes out - this will effectively seal the edges at the same time.



Use a pin gun or hammer and panel pins to keep everything in place whilst the glue sets. If using panel pins these can be left protruding and then pulled out when the panels are dry.

Clean up any glue that squeezes out with a dry brush before it sets - this will also help seal the edges at the same time.



If any sockets do coincide with the verticals it is a straightforward job to cut around them if they cannot easily be moved.



FINISHING TOUCHES

WHAT A DIFFERENCE A BIT OF PANELLING MAKES!



Once the panelling is complete the task of decorating can begin. A quick “wipe” of all the edges with medium grit sandpaper will remove sharp arrises. Use fine surface filler to fill any gaps and then fine sandpaper to prepare for painting.

Apply a good quality universal primer and this will show up any areas that may still need attention. When complete apply two coats of water based eggshell and prepare to be amazed as this final stage is the one that really brings the project together!



PANELLING STAIRCASES

TO PANEL OR NOT TO PANEL!



One of the most common questions we get asked is how can the staircase be dealt with when panelling in a hallway. As the angle of staircases varies from property to property it is not possible to produce pre-cut angled sheets but there are some options. With our Georgian design it is simply a case of working out the angle and cutting down our Tall panels into a series of parallelograms. The alternative is to panel to ceiling height and simply run it into the stairs as was commonly done with traditional wood panelling (see left). You could do this with either our Full Size Georgian, Short Victorian or Jacobean designs.

If you are wanting to use the Open Backed designs parallel with the stairs it is best to get a local DIY store to run off a quantity of strips of 9mm mdf (some offer a free cutting service) and cut the verticals to suit your stairs. This sounds more difficult than it is as they should all be the same once the angle has been worked out!

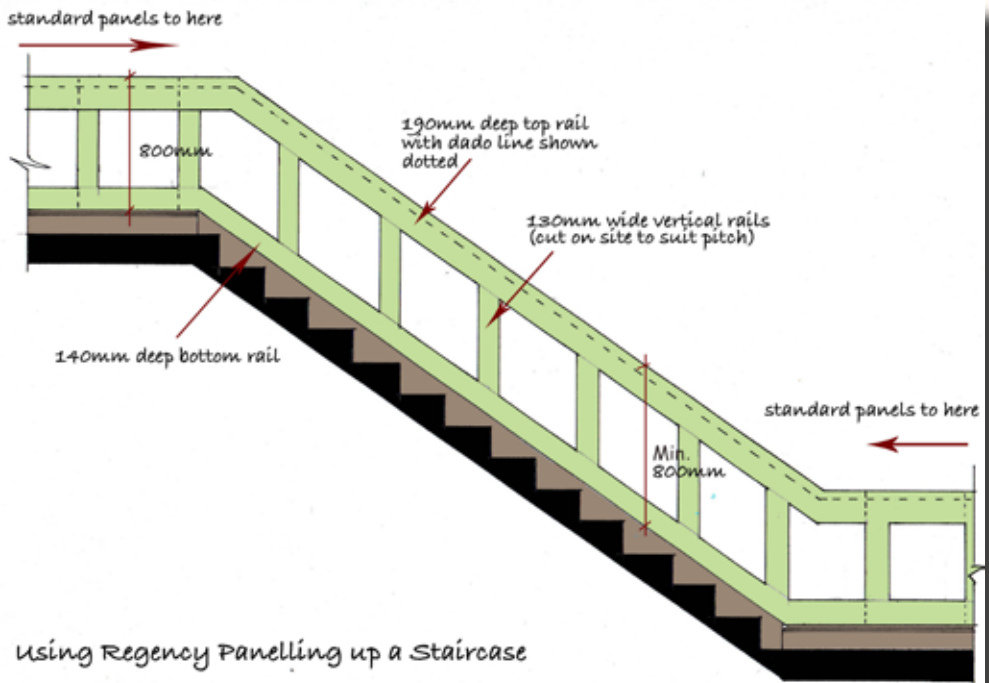

RADIATORS

HOW TO DEAL WITH THEM

In an ideal world the panelling would be done before any first fix plumbing. However as the panels are only 9mm thick it will be possible in nearly all cases to cut them so that they simply slip behind and around the radiator supports without removing it first.

With our Open Backed designs you could of course incorporate these into a radiator cover by fitting mdf or brass grill to the cut out squares/rectangles but you will have to allow for a means of removing the casing for when valves need to be adjusted or radiators bled etc.

A much simpler option if you wish to reduce the visual impact of a modern (and usually ugly!) radiator is to fit a Radiator Table such as the one here from **Scumble Goosie**. The Georgian Wide Joint panelling, Radiator Table and radiator have all been painted in “Livid” by The Little Greene Paint Company.



SCUMBLE GOOSIE

OUR SISTER COMPANY

We couldn't finish this brochure without dedicating a little bit of space to our sister company! **Scumble Goosie**, established since 1990, designs and handmakes a wide range of traditionally styled furniture and accessories. Working mainly in solid mango hardwood we are also able to customise the size and even the design of the furniture to suit your requirements. Our furniture can be purchased in its raw wood state or we can paint it in one of our six House Colours. Other finishes such as wax, varnish and bespoke paint finishes are also available.

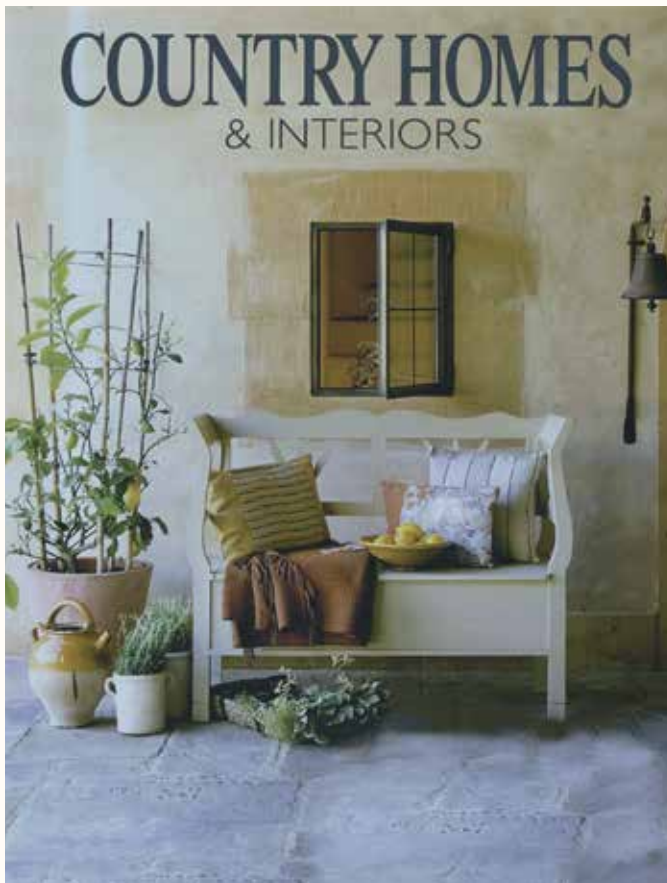

Our Country Wooden sofa is just one of many Scumble Goosie pieces that magazines such as Country Homes & Interiors regularly feature on their pages. To see the full range of what we do please go to www.scumblegoosie.com

SCUMBLE GOOSIE

EXTRAORDINARY NAME. EXTRAORDINARY FURNITURE.



Our Classic Armoire is available with shelves or a hanging rail and, like all of our furniture, can be altered in size (and even design) to suit customer requirements. Bespoke paint finishes are also available.

PRICE LIST

Prices are per piece and **include** VAT.

All sizes are in mm.

ALL panels are made from best quality Moisture Resistant MDF

GEORGIAN

TYPE	SIZE (W X H)	1 - 29 PCS	30 - 89 PCS	90+ PCS
SHORT	600 X 800	£16.50	£14.00	£10.75
TALL	600 X 1200	£23.00	£20.00	£16.00
		1 - 9 PCS	10 - 19 PCS	20+ PCS
FULL SIZE	1220 X 2440	£69.00	£59.00	£49.00

EDWARDIAN

TYPE	SIZE (W X H)	1 - 29 PCS	30 - 89 PCS	90+ PCS
SHORT	600 X 800	£17.00	£14.50	£11.25
TALL	600 X 1200	£24.00	£21.00	£17.00

VICTORIAN

TYPE	SIZE (W X H)	1 - 29 PCS	30 - 89 PCS	90+ PCS
SHORT	600 X 800	£17.00	£14.50	£11.25
TALL	600 X 1200	£24.00	£21.00	£17.00

REGENCY

TYPE	SIZE (W X H)	1 - 29 PCS	30 - 89 PCS	90+ PCS
SHORT	600 X 800	£17.00	£14.50	£11.25

JACOBAN

TYPE	SIZE (W X H)	1 - 29 PCS	30 - 89 PCS	90+ PCS
SMALL	400 X 1200	£17.00	£14.50	£11.25
LARGE	600 X 1200	£24.00	£21.00	£17.00

FRAMING STRIPS

TYPE	SIZE	EACH	USE FOR
FS1	100 x 800	£1.75	Short Vic/Ed vertical rails
FS2	100 x 1200	£2.00	Tall Vic/Ed vertical rails and Short Vic horizontal rails Large Jacobean vertical and horizontal rails
FS3	130 x 800	£2.00	Regency vertical rails
FS4	75 x 1200	£2.00	Small Jacobean vertical and horizontal rails

DADO AND PICTURE RAILS

TYPE	SIZE	PRICE EACH
DEEP REBATED DADO (DADO1)	39 x 67 x 2400	£13.00
SIMPLE FACE FIXED DADO (DADO2)	26 x 57 x 2400	£9.50
SHALLOW REBATED DADO (DADO3)	20 x 67 x 2400	£11.00
REBATED PICTURE RAIL (PIC1)	27 x 44 x 2400	£11.00

BEADING

SIZE	PRICE	DESCRIPTION
9 x 20 x 470	£4.75	Set of 4 pieces pre-mitred for Regency panels
9 x 20 x 2400	£3.50	Single long length. Not mitred.

DELIVERY CHARGES

(Mainland UK excluding Highlands & Islands. Please call for export)

ORDERS TOTALLING UNDER £50	£9.00
ORDERS TOTALLING BETWEEN £50 AND £99	£19.00
ORDERS TOTALLING £100 AND OVER	£29.00
ORDERS INCLUDING FULL SIZE SHEETS OF GEORGIAN PANELLING	£39.00

How do I calculate how many panels I need?

If you are just running a single row of panels (eg Georgian Tall) we suggest adding up the total number of linear metres you are covering and dividing that by the width of the panel. So to do a 10m run with Georgian Tall, for example, it would be 10 divided by 0.6 which would work out at 17 panels.

If you intend to cover most or all of a wall with panelling such as Short Victorian or Jacobean it is probably easier to work out the area in square metres and divide that figure by the area of the panel you are using (eg Short Victorian = 0.48 sq m).

We recommend allowing a wastage factor of about 5% for all designs. This will also assist with the setting out. Contact us if you need any advice on quantities.

COTSWOLD SHOWROOM

If you can, do pop and see us!

Part of Scumble Goose, we are based in the Cotswolds and have an extensive showroom featuring 12 Roomsets full of panelling, furniture, gifts and accessories. We can show you the various types of panelling in actual room settings making it easier to envisage what the panelling will look like in your home.



Open 7 days a week (call or see website for opening times) and there are lovely pubs serving good food nearby! Parking right outside.



Panelling can be collected from the showroom but please check availability first.



A visit will fill you with inspiration and ideas....



THE ENGLISH PANELLING COMPANY

GRIFFIN MILL•LONDON RD•THRUPP•GLOUCESTERSHIRE•GL5 2AZ

01453 731305

www.englishpanelling.com